



Travel made easy 

MUST READ INSTRUCTION OR VOID WARRANTY

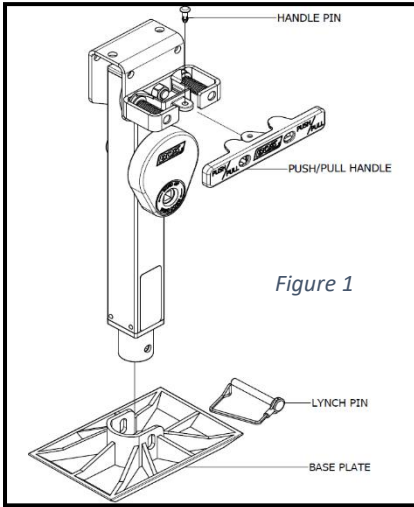

Figure 1

Figure 1: shows the way to attach the Push/Pull Handle and the base plate.

Figure 2: shows the angle you can put the legs at, 30 degrees each way, you can only lift in a vertical position.



DO NOT USE:

- IMPACT DRIVER
- AIR TOOLS
- HOME MADE TOOLS
- DRILL ON HAMMER

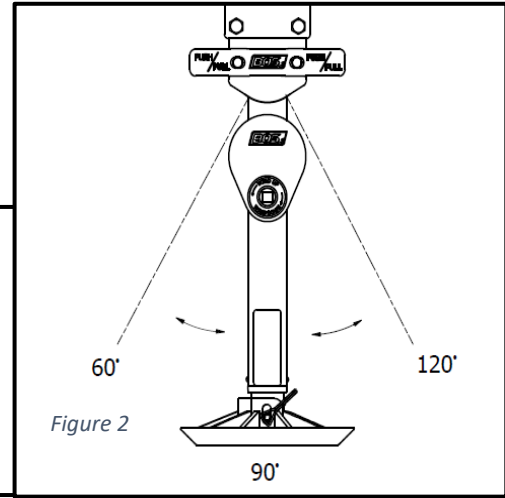

Figure 2

Figure 4: Before you insert the drive piece make sure you are turning it in a clockwise direction.

The inner pipe can spin by itself with the baseplate attached, when extending. Until it touches the ground. This will also happen when retracting the inner pipe.

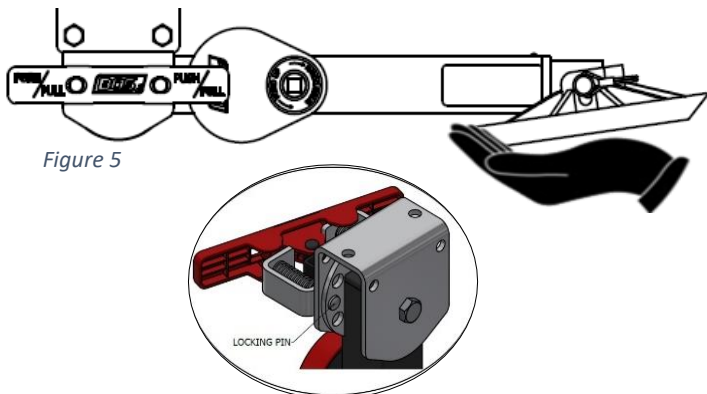
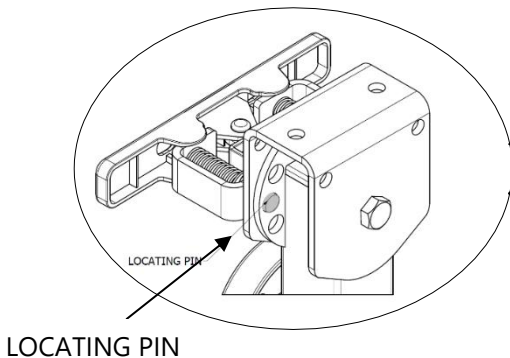

Figure 5

Figure 5: shows the best way to swing your stabiliser legs, when you take a bit of the weight it will make it easier to push/pull the red handle.

Figure 6: shows the way to use the red push/pull handle, with only one hand you can push/pull on either side of the handle no need to pull the centre.

Make sure you check the pins have locked into place.



LOCATING PIN

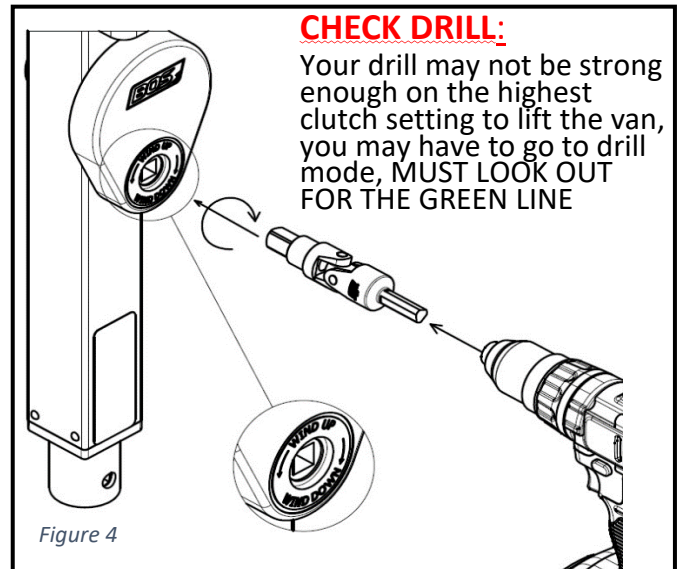

Figure 4

We recommended an 18V drill with 45-50Nm of torque that has a clutch, if you find out your drill is not strong enough, it could be that it is old or is not lithium, if it is a lithium but still does not lift. You can set it on drill mode but you will need to pay attention to the green line.

Do not retract the legs all the way.

This will cause them to lock up.

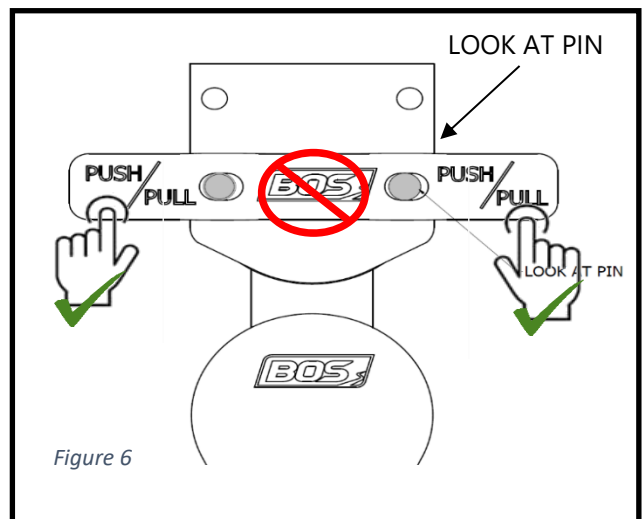

Figure 6



Travel made easy 

MUST READ INSTRUCTION OR VOID WARRANTY

Once you have the legs set up in a vertical position, you can start leveling your van. If you do need to lift your tyres off the ground to get it level you will need to go past the level point, chock the tyres and lower it back down on to the chocks to level. **As you always need the tyres to touch the ground.**

Below Figure 8 shows the chocking of the wheel.

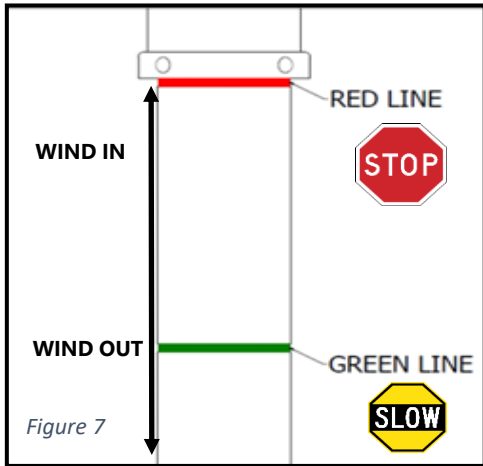

GREEN LINE: SLOW DOWN. You are close to maximum travel.

RED LINE: STOP. You have reached maximum travel.



“CHANGING YOUR FLAT TYRE”

When you need to change your tyre, you need to lift them (tyres) of the ground, do this by making sure the van is still connected to the tow vehicle. From front to back lift the leg by 50mm each time. **DO NOT LIFT 1 LEG UP ALL THE WAY.** You may need to use an extension to get the tyres of the ground depends on the type of suspension your van has.

General common instructions:

Do not store the trailer with the wheels off the ground.

Use pipe extensions to reduce the amount of inner pipe exposed

100mm Extensions are NOT interchangeable with the 120mm extensions.

100mm Extensions = Stabiliser Legs

Make sure dual wheels are inline when using the jockey and stabiliser legs as side movement will happen.

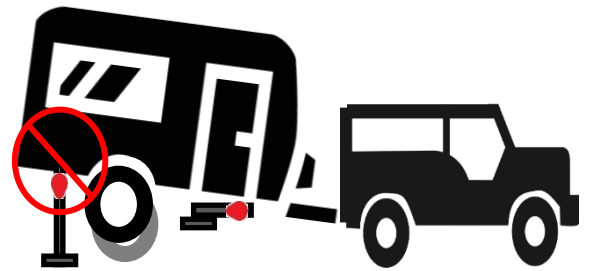

Use & maintenance

Most important is do not ever push the drill when using the drill, this action will put pressure on the gearbox and cause damage.

Greasing the unit, depending on the amount of time you use the unit, grease it every couple of months, we use a tack grease so a wheel bearing grease if fine.

Grease the unit when the inner pipe is retracted. (This will stop you from over greasing)

If you have put too much grease in and it is coming out where you insert the drill drive piece, just unscrew the red cover and clean up the grease around the small gear.